

# LUZHNIKI

C O L L E C T I O N

12 CLUBHOUSES IN KHAMOVNIKI

PREMIUM RESIDENTIAL COMPLEX IN KHAMOVNIKI.  
THE LUZHNIKI COLLECTION IS A GROUP  
OF 12 CLUBHOUSES SET IN A PRIVATE PARK ON  
THE BANK OF THE MOSCOW RIVER, JUST 50 M FROM  
THE ENTRANCE TO THE LUZHNIKI OLYMPIC COMPLEX.

ARRANGED IN GROUPS OF 4,  
THE LUZHNIKI COLLECTION CLUBHOUSES ARE  
AN ARCHITECTURAL METAPHOR OF A FLAWLESS LANDSCAPE:



WATERFRONT



GARDEN



HIGHLINE



MOUNTAIN LINE

12  
CLUBHOUSES

## COLLECTION

## SAFETY

PRIVATE GROUNDS  
AND MODERN  
SECURITY SYSTEMS

5,3 HA SHADY ALLEYS  
AND WALKING  
ROUTES

## PRIVATE PARK

## AMENITIES

RESIDENTS-ONLY  
INTERNAL  
INFRASTRUCTURE

50 M FROM THE ENTRANCE  
TO THE LEGENDARY  
LUZHNIKI OLYMPIC  
COMPLEX

## LOCATION

## LUZHNIKI OLYMPIC COMPLEX

AN ICONIC LOCATION  
FOR SPORT  
AND LEISURE

HISTORICAL  
CENTER  
OF MOSCOW

## KHAMOVNIKI

## LOBBIES

DESIGNED  
BY ODA ARCHITECTURE  
(NEW YORK, USA)

UNIQUE VIEWS  
OF THE EMBANKMENTS  
AND THE VOROBYOVY GORY  
NATURE RESERVE

## LIFE BY THE RIVER

## DROP-OFF

CAR ENTRANCE  
ON PAR WITH  
THE WORLD'S  
BEST HOTELS

APARTMENTS  
WITH A SEPARATE  
ENTRANCE  
FOR THE STAFF

## PRIVACY

## PARKING

TWO-LEVEL  
UNDERGROUND  
CAR PARKING AREA

MORE THAN  
150 LAYOUT  
OPTIONS

## WIDE SELECTION

## ERGONOMICS

UP TO 88 M BETWEEN  
THE CLUBHOUSES



# LUZHNIKI COLLECTION

A COLLECTION  
OF TWELVE CLUBHOUSES  
SET IN A PRIVATE PARK  
ON THE BANK OF THE  
MOSCOW RIVER CLOSE  
TO THE LEGENDARY  
LUZHNIKI OLYMPIC  
COMPLEX.





# LUZHNIKI COLLECTION

THE LUZHNIKI COLLECTION  
PROJECT WAS CREATED  
BY AN INTERNATIONAL TEAM  
OF ARCHITECTS AS AN  
AESTHETIC ARCHITECTURAL  
ENSEMBLE IN WHICH EVERY  
PENTHOUSE AND  
APARTMENT IS A UNIQUE  
PIECE OF COLLECTIBLE  
REAL ESTATE.





# KHAMOVNIKI







# KHAMOVNIKI: IN DETAIL

- 1 LUZHNIKI COLLECTION
- 2 ENTRANCE TO THE LUZHNIKI OLYMPIC COMPLEX
- 3 BIG SPORTS ARENA
- 4 LUZHNIKI WATER SPORTS PALACE
- 5 NOVODEVICHY CONVENT
- 6 MOSCOW STATE UNIVERSITY
- 7 GORKY PARK
- 8 NESKUCHNY GARDEN
- 9 RUSSIAN ACADEMY OF SCIENCES
- 10 VOROBYOVY GORY NATURE RESERVE
- 11 TRUBETSKOY ESTATE
- 12 VALLEY OF THE SETUN RIVER NATURE RESERVE
- 13 MOSCOW CITY INTERNATIONAL BUSINESS CENTER

THE LUZHNIKI COLLECTION IS AN EXCLUSIVE RESIDENTIAL COMPLEX CREATED BY ABSOLUTE PREMIUM SET IN A SECLUDED PART OF THE KHAMOVNIKI DISTRICT AND PRIMARILY DESIGNED FOR THOSE WHO LIKE TO CAREFULLY INVEST IN EXCEPTIONAL COMFORT.



# KHAMOVNIKI: LEISURE AND RECREATION



## SPORT

LUZHNIKI OLYMPIC COMPLEX  
ICE PALACE KRISTALL  
BOSCO TENNIS CLUB  
BUREVESTNIK  
AQUA COMPLEX

## PARKS

VOROBYOVY GORY  
NESKUCHNY GARDEN  
GORKY PARK  
MUZEON PARK OF ARTS  
MANDELSTAM GARDEN

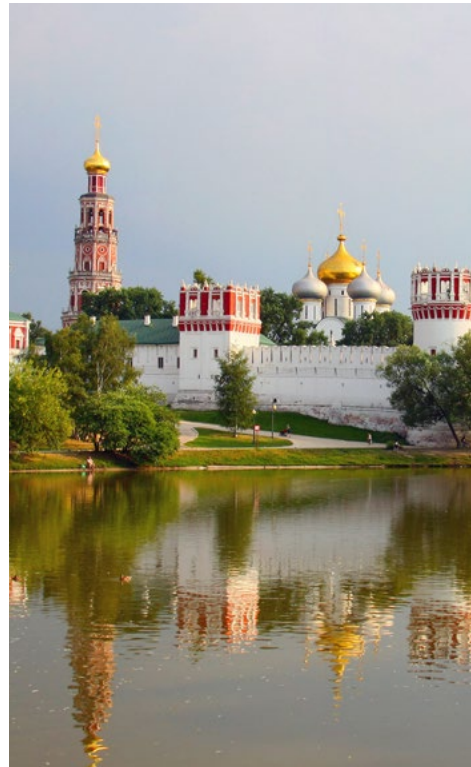

## CULTURE

TRUBETSKOY ESTATE  
NOVODEVICHY MONASTERY  
MOSCOW MUSEUM  
OF MODERN ART  
MOSCOW PALACE  
OF YOUTH



## BUSINESS

LUZHNIKI COLLECTION  
BUSINESS CENTER  
KRASNAYA ROZA  
BUSINESS CENTER  
LUCH BUSINESS CENTER  
MOSCOW SILK  
BUSINESS CENTER  
FUSION PARK  
BUSINESS CENTER

## FOR CHILDREN

PARIS SAINT-GERMAIN  
FOOTBALL ACADEMY  
SCHOOL OF ART  
MOSCOW STATE ACADEMY  
OF CHOREOGRAPHY



## RESTAURANTS

MØS  
HIBIKI  
COFFEEMANIA  
SEMIFREDDO  
LASTOCHKA  
SEIJI  
CIHAN STEAK & KEBAB  
DUE FORNI  
USACHEVSKY MARKET

## HIGHER EDUCATION

MOSCOW STATE  
UNIVERSITY  
MOSCOW STATE  
PEDAGOGICAL  
UNIVERSITY  
MIREA — RUSSIAN  
TECHNOLOGICAL  
UNIVERSITY  
MOSCOW STATE  
LINGUISTIC  
UNIVERSITY



# LUZHNIKI COLLECTION

ARRANGED IN FOUR COLLECTORS' GROUPS,  
THE LUZHNIKI COLLECTION CLUBHOUSES  
REPRESENT AN ARCHITECTURAL METAPHOR  
OF THE OUTSTANDING LOCAL LANDSCAPE.



## WATERFRONT (W1, W2, W3, W4, W5)

THE FIRST LINE OF CLUBHOUSES  
ON THE LUZHNETSKAYA EMBANKMENT  
OF THE MOSKVA RIVER



## GARDEN (G1, G2, G3)

CLUBHOUSES LOCATED  
IN A SHADY GARDEN  
IN THE MIDDLE  
OF A PRIVATE PARK



## HIGHLINE (HL1, HL2, HL3)

CLUBHOUSES BORDERING  
THE PRIVATE PARK AND OFFERING VIEWS  
OF THE DYNAMIC MOSCOW CITY



## MOUNTAIN LINE (ML)

THE ARCHITECTURAL ENSEMBLE  
OF THREE RESIDENTIAL TOWERS  
POSITIONED ALONG THE PIAZZA



1 ENTRANCE TO THE LUZHNIKI OLYMPIC COMPLEX (50 M)

2 CULTURAL & ENTERTAINMENT CENTER

3 RETAIL GALLERY

4 PIAZZA

5 MOUNTAIN LINE OFFICE

6 WATERFRONT OFFICE



# LUZHNIKI COLLECTION

## SITE PLAN



### WATERFRONT

W1 — 18 FLOORS  
W2 — 18 FLOORS  
W3 — 18 FLOORS  
W4 — 18 FLOORS  
W5 — 18 FLOORS



### GARDEN

G1 — 18 FLOORS  
G2 — 18 FLOORS  
G3 — 17 FLOORS



### HIGHLINE

HL1 — 18 FLOORS  
HL2 — 17 FLOORS  
HL3 — 12 FLOORS



### MOUNTAIN LINE

ML — 16-18 FLOORS  
(WHITE-BOX FINISHED)





# VIEWS FROM THE WINDOWS

THE DISTINCTIVE  
FEATURES OF THE  
APARTMENTS OF THE  
LUZHNIKI COLLECTION  
CLUBHOUSES INCLUDE  
PANORAMIC VIEWS  
OF MANY OF THE CAPITAL'S  
MAIN ATTRACTIONS.



*VOROBYOVY  
GORY*

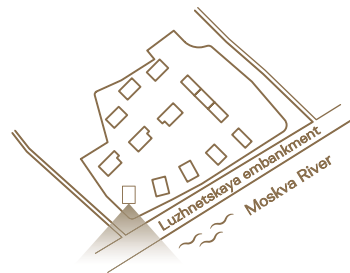

THE VIEW  
OF THE MOSKVA RIVER  
AND THE NATURE  
RESERVE WILL REMAIN  
INTACT FOR DECADES







LUZHNIKI  
OLYMPIC  
COMPLEX

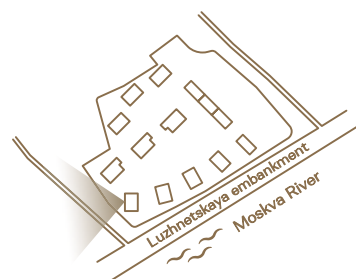

MOSCOW IS RENOWNED  
FOR THE DIVERSITY  
OF ITS ARCHITECTURE  
AND THE HARMONIOUS  
USE OF OPEN SPACE







MOSCOW CITY



MOSCOW'S  
MODERN VISTA

LUZHNIKI / 12  
COLLECTION







KHAMOVNIKI



VIEWS OF THE CAPITAL'S  
HISTORIC CENTER  
AND PARKS  
AND SQUARES  
OF OLD MOSCOW





# PROJECT ARCHITECTURE





# PROJECT ARCHITECTURE

---

FACADES FINISHED  
WITH PREDOMINANTLY  
NATURAL MATERIALS

---

PANORAMIC  
GLAZING

---

MORE THAN 150  
APARTMENT  
LAYOUT OPTIONS

---

OPEN TERRACES  
WITH VIEWS  
OF THE RIVER

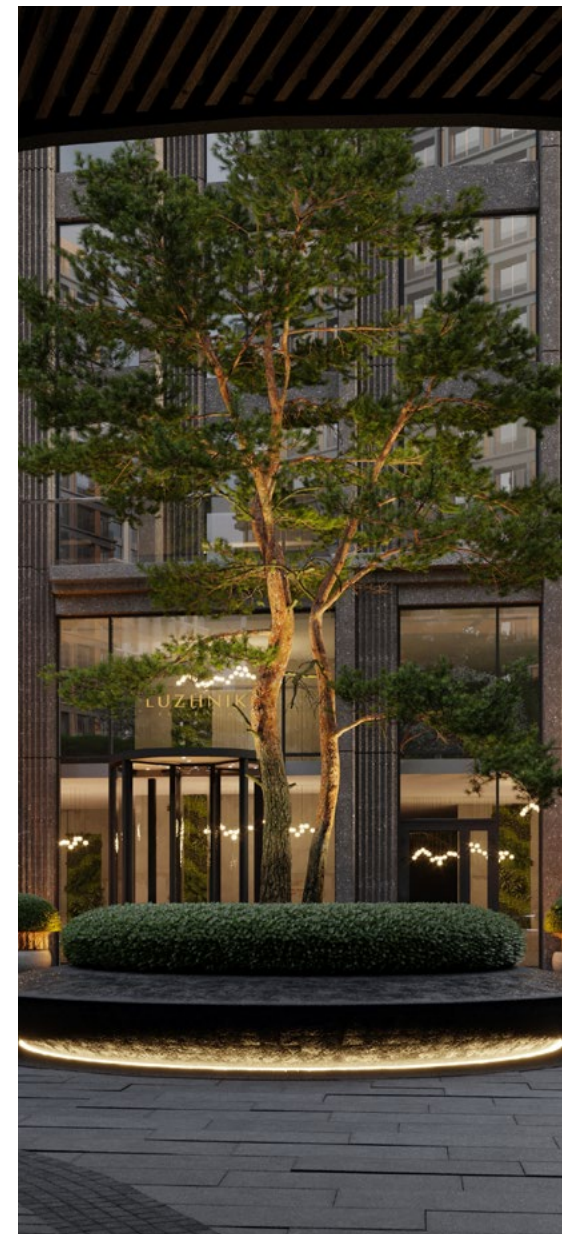

A GROUP OF WORLD-FAMOUS PROFESSIONALS  
WERE BROUGHT TOGETHER TO WORK  
ON THE PROJECT. THE DESIGN  
OF THE RESIDENTIAL COMPLEX WAS  
ENTRUSTED TO TWO OF THE WORLD'S  
LEADING ARCHITECTURAL BUREAUS,  
DYER (UNITED KINGDOM) AND MVRDV  
(THE NETHERLANDS).

THE SOLUTIONS PUT FORWARD EMPHASIZE  
THE COMFORT AND EXCLUSIVITY  
OF THE ACCOMMODATION.



# WATERFRONT

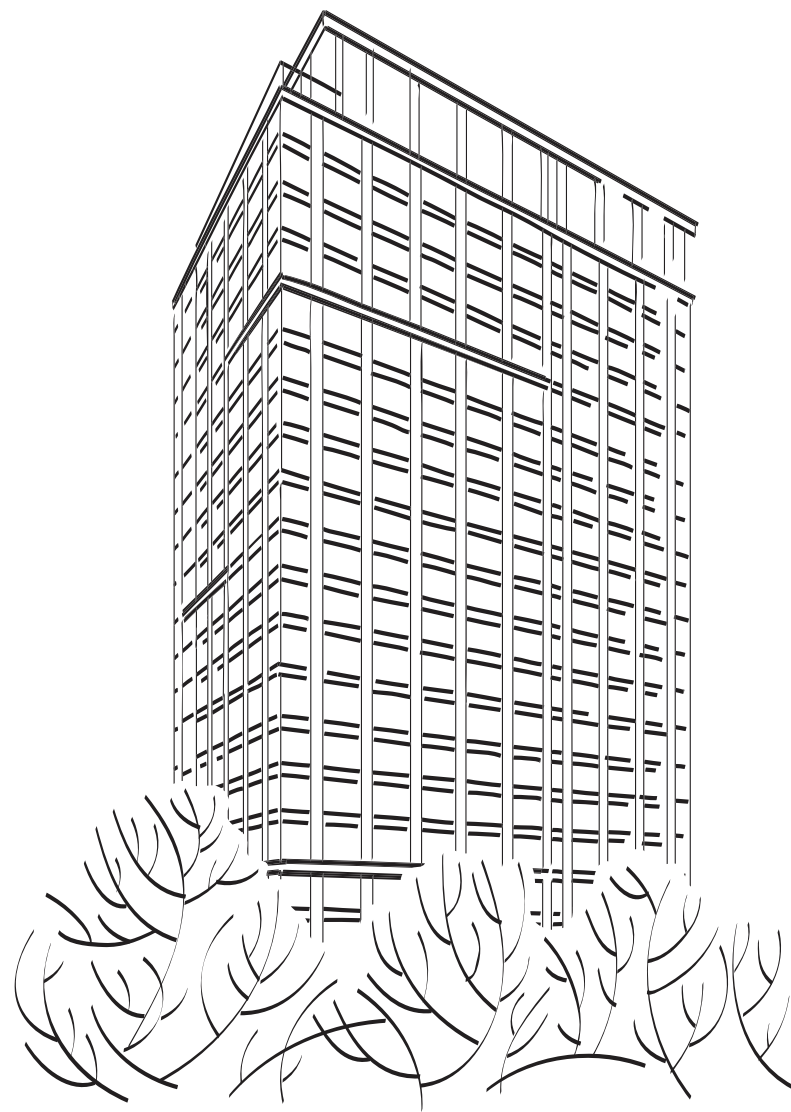

| MOSKVA RIVER • VOROBYOVY GORY • PRIVATE PARK • EMBANKMENTS |

WATERFRONT

## *CLUBHOUSES* ON THE LUZHNETSKAYA *EMBANKMENT*





# WATERFRONT: IN DETAIL\*

LOBBY FLOOR  
AREAS RANGE FROM  
250 TO 300 SQ. M

1 APARTMENT  
PER LOBBY

LOBBY CEILING  
HEIGHT — 8 M

PENTHOUSES

PRIORITY PARKING

PRIORITY CELLARS

NO MORE THAN  
79 APARTMENTS  
IN EACH  
CLUBHOUSE

SEPARATE  
ELEVATOR LOBBY  
FOR EACH  
APARTMENT

APARTMENTS  
WITH FLOOR  
AREAS FROM  
55 TO 255 SQ. M

2 ENTRANCES:  
A FRONT 1 AND  
1 FOR THE STAFF

CEILING HEIGHT:  
APARTMENTS — 3,25 M,  
PENTHOUSES — 4,65 M

SEPARATE AREAS  
FOR TECHNICAL  
SERVICES AND  
HOUSEHOLD WASTE

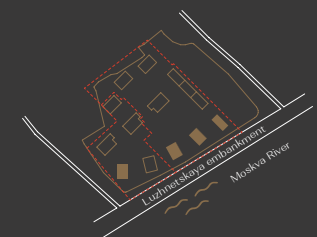

\*WATERFRONT CLUBHOUSE 1 OFFERS DISTINCTIVE APARTMENT LAYOUTS AND EXCELLENT ENGINEERING SOLUTIONS



# WATERFRONT: FRONT LOBBIES\*

THE CLUBHOUSES LOCATED ON THE LUZHNETSKAYA EMBANKMENT FOLLOW MARKEDLY LUXURIOUS MINIMALISM. AN EIGHT-METER EXPANSE OF PANORAMIC GLAZING ALLOWS THE SPACIOUS LOBBY AREAS TO BE FLOODED WITH SUNLIGHT.

LUZHNIKI / 18  
COLLECTION



\*WATERFRONT CLUBHOUSE 1 OFFERS DISTINCTIVE APARTMENT LAYOUTS AND EXCELLENT ENGINEERING SOLUTIONS

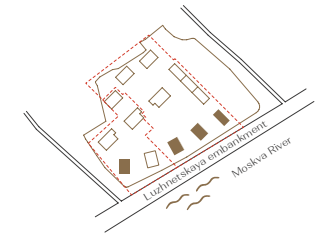

THE WAVE-SHAPED DECORATIVE PANELS ON THE LOBBY WALLS ADD TO THE WATER THEME.

DESIGNER CHANDELIERS, NATURAL FINISHING MATERIALS, FIREPLACES, AND COZY FURNITURE CREATE AN INTIMATE ATMOSPHERE OF EXCEPTIONAL COMFORT.



# WATERFRONT: DESIGN CONCEPT\*



\*WATERFRONT CLUBHOUSE 1 OFFERS DISTINCTIVE APARTMENT LAYOUTS AND EXCELLENT ENGINEERING SOLUTIONS

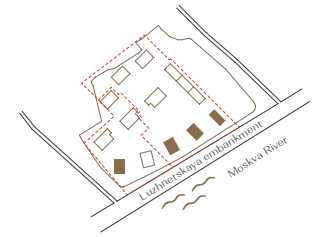



# GARDEN

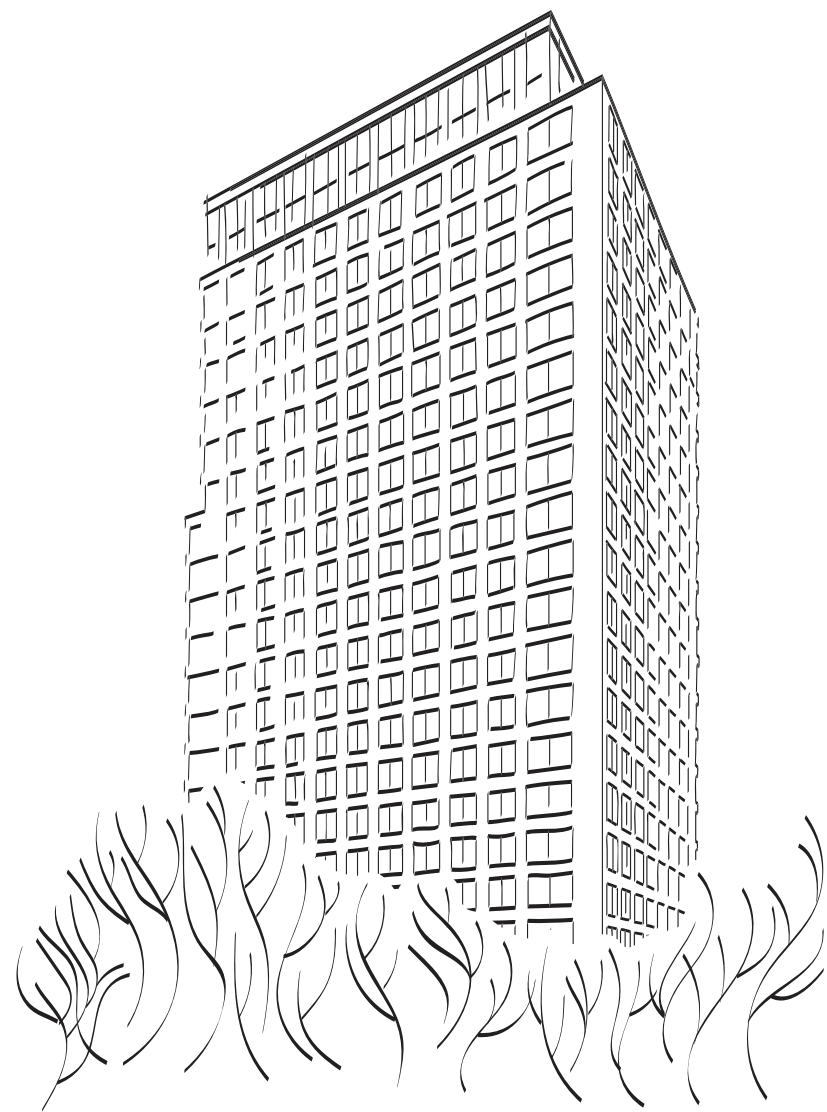

| PRIVATE PARK • WALKING AREAS •  
MOSKVA RIVER • RUSSIAN ACADEMY OF SCIENCES |

GARDEN

*CLUBHOUSES*  
LOCATED  
*IN THE SHADY*  
GARDEN



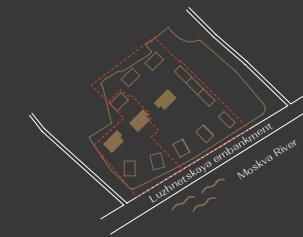

# GARDEN: IN DETAIL

LOBBY FLOOR  
AREAS RANGING  
FROM 224  
TO 332 SQ. M

3 TO 4  
APARTMENTS  
PER LOBBY

LOBBY CEILING  
HEIGHT — 8 M

SPACIOUS APARTMENTS  
WITH FLOOR AREAS  
RANGING FROM 75  
TO 336 SQ. M

APARTMENTS WITH  
PRIVATE TERRACES  
ON FLOORS 10 TO 12



CEILING HEIGHT:  
APARTMENTS — 3,25 M,  
PENTHOUSES — 4,65 M

EACH ENTRANCE  
HAS 3 ELEVATORS  
FOR RESIDENTS  
AND A SERVICE 1

PENTHOUSES



# GARDEN: FRONT LOBBIES

THE GENERAL THEME OF BEING ONE WITH NATURE, EVEN HERE IN THE VERY HEART OF THE CAPITAL CITY, IS SUPPORTED BY WALLS ADORNED WITH LANDSCAPE ART AND THE NATURAL MATERIALS USED IN INTERIOR DESIGN.

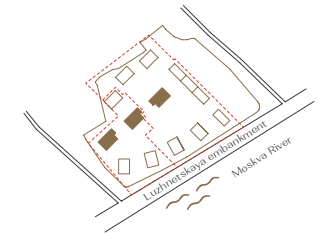

THE CLUBHOUSES LOCATED IN THE SHADY GARDENS OF THE PRIVATE PARK AREA THE EMBODIMENT OF NATURAL MINIMALISM. THE ACTIVE USE OF WOOD AND STONE AS WELL AS VERTICAL AND WINTER GARDENS IN THE LOBBY AREAS LEND THE LUZHNIKI GARDEN COLLECTION AN ESPECIALLY WARM AND RELAXING ATMOSPHERE.



# GARDEN: DESIGN CONCEPT

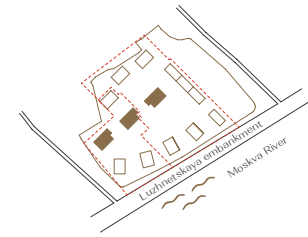



# HIGHLINE

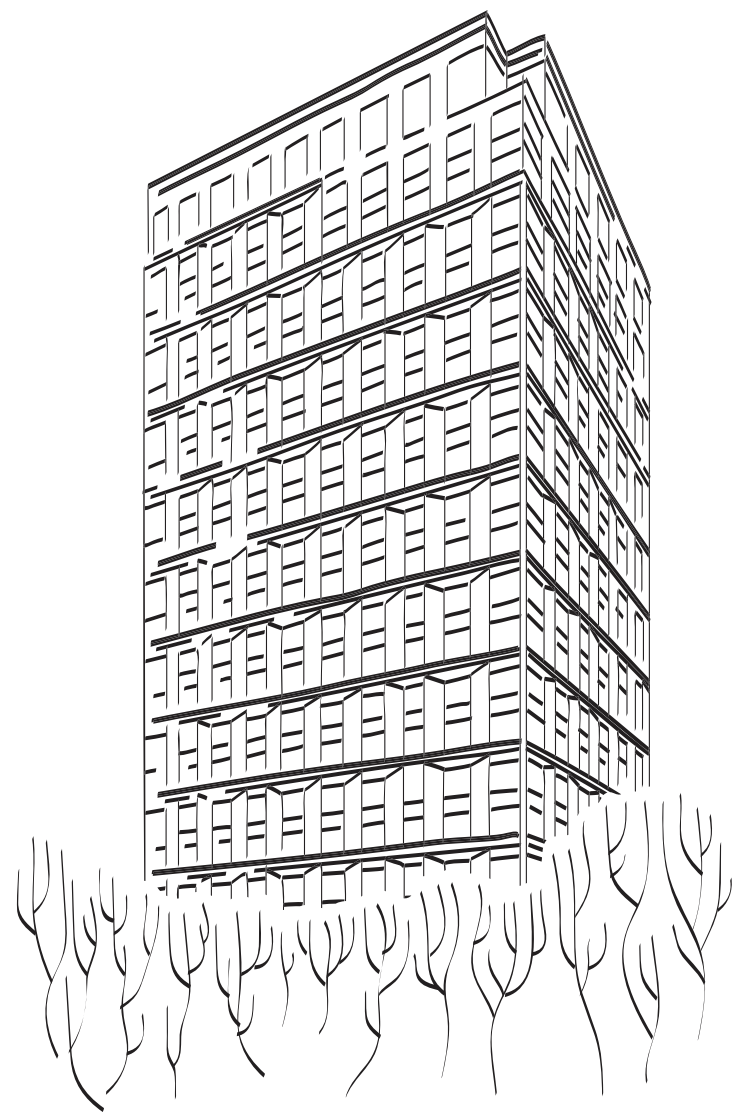

| MOSCOW CITY • LUZHNIKI OLYMPIC COMPLEX •  
PRIVATE PARK • MOSCOW STATE UNIVERSITY |

HIGHLINE

*CLUBHOUSES  
LOCATED DEEP  
IN THE PARK*





# HIGHLINE: IN DETAIL

APARTMENTS  
WITH FLOOR  
AREAS RANGING  
FROM 55  
TO 255 SQ. M

2 TO 4  
APARTMENTS  
PER LOBBY

EACH ENTRANCE  
HAS 3 ELEVATORS  
FOR RESIDENTS  
AND A SERVICE 1

CEILING HEIGHTS:  
APARTMENTS — 3,25 M,  
PENTHOUSES — 4,73 M

LOBBY FLOOR  
AREAS FROM 150  
TO 200 SQ. M

LOBBY CEILING  
HEIGHT — 8 M

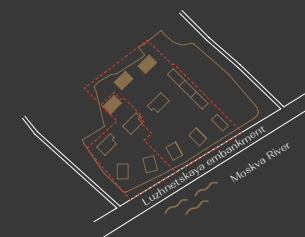

PENTHOUSES

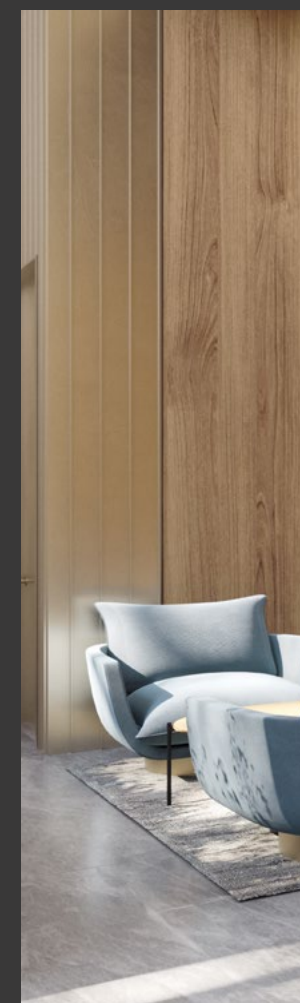



# HIGHLINE: FRONT LOBBIES

THE HIGHLINE CLUBHOUSES BORDERING THE PRIVATE PARK ARE FOR THOSE WHO APPRECIATE A STRONG URBAN STYLE WITH A CONTEMPORARY INTERIOR.

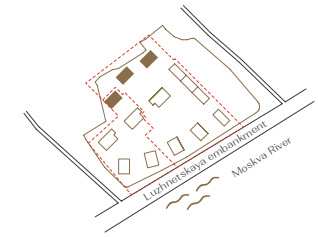

A HARMONIOUS MIX OF CLASSICAL ELEGANCE AND DISCRETE MINIMALISM WHERE GEOMETRICAL LIGHTING FIXTURES COMPLEMENT METAL DECORATIVE ITEMS.



# HIGHLINE: DESIGN CONCEPT

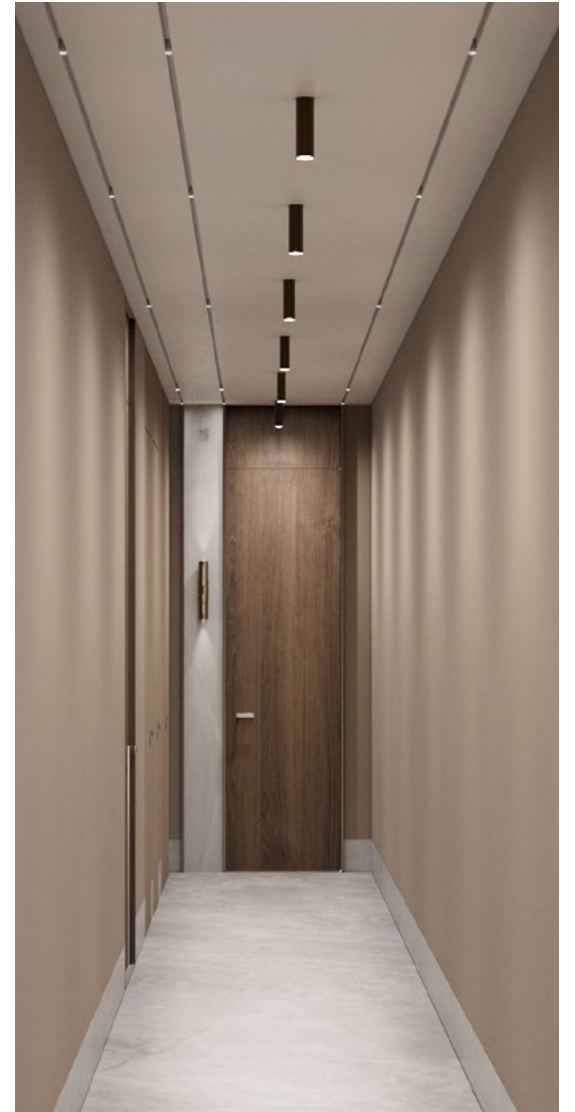
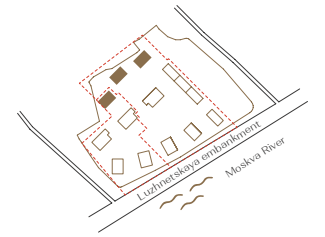



# MOUNTAIN LINE

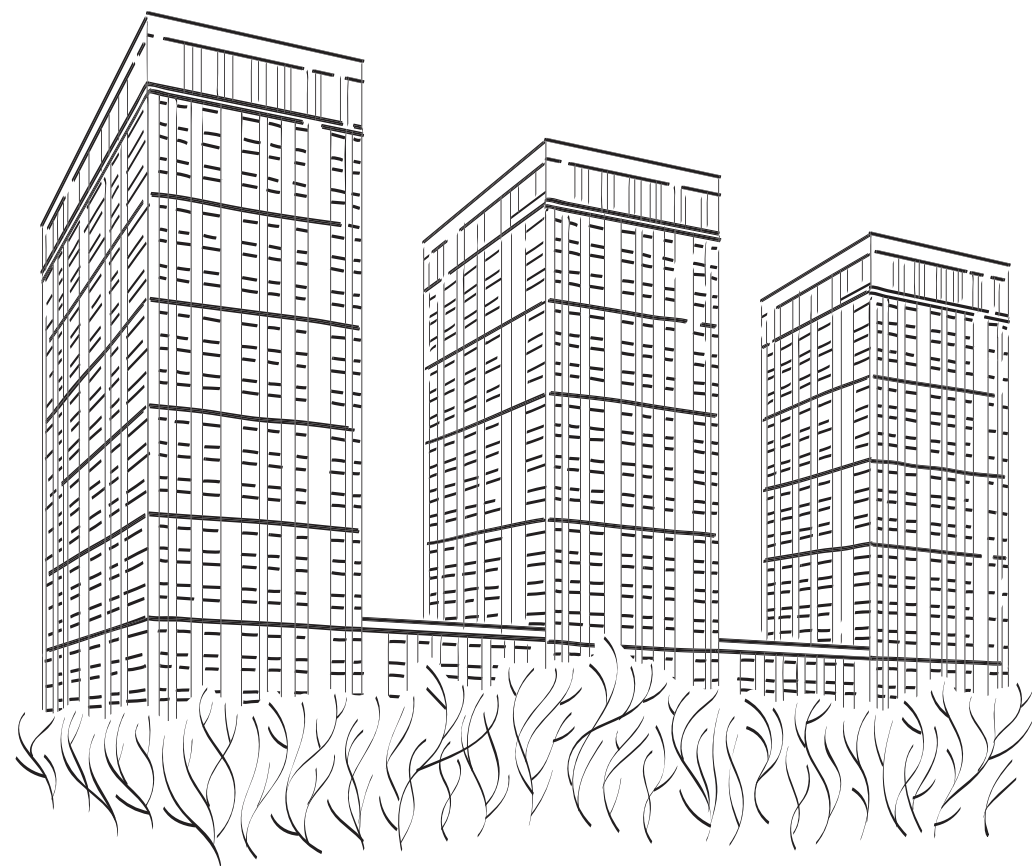

| PIAZZA • PRIVATE PARK • OBJETS D'ART • KHAMOVNIKI |

MOUNTAIN LINE

*AN ARCHITECTURAL  
ENSEMBLE  
OF THREE TOWER  
BLOCKS*





# MOUNTAIN LINE: IN DETAIL

2 SPACIOUS  
LOBBIES

EACH ENTRANCE  
HAS 2 ELEVATORS  
FOR RESIDENTS  
AND A SERVICE 1

COMPACT AND COZY  
APARTMENTS WITH  
FLOOR AREAS  
RANGING FROM 48,8  
TO 146 SQ. M

MOUNTAIN LINE  
CLUBHOUSE  
APARTMENTS  
ARE ALL WHITE-BOX  
FINISHED

PENTHOUSES

CEILING HEIGHTS:  
APARTMENTS — 3,25 M,  
PENTHOUSES — 4,7 M

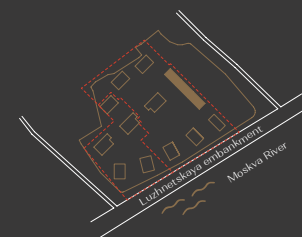

LOBBY FLOOR  
AREAS RANGING  
FROM 150  
TO 200 SQ. M

3 TO 8  
APARTMENTS  
PER LOBBY

LOBBY CEILING  
HEIGHT — 8 M

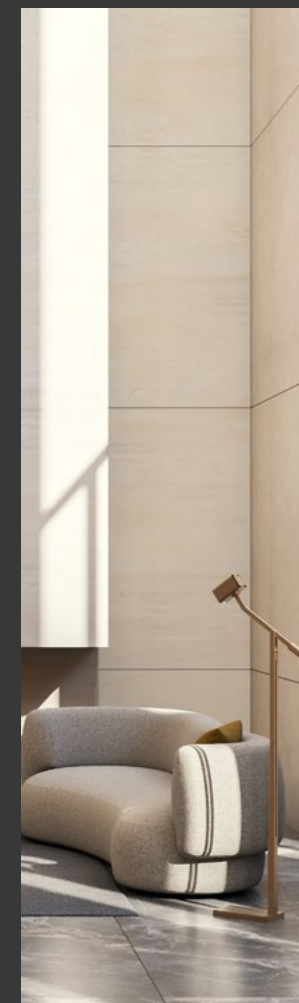
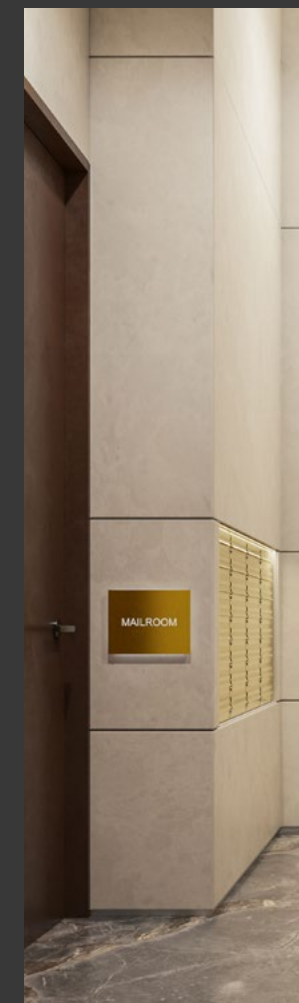



# MOUNTAIN LINE: FRONT LOBBIES

AN ARCHITECTURAL  
METAPHOR  
OF THE HIGHLANDS,  
THE LOBBY INTERIORS  
SET THE CORE THEME  
OF A BOUNDLESS  
MOUNTAIN ENVIRONMENT.

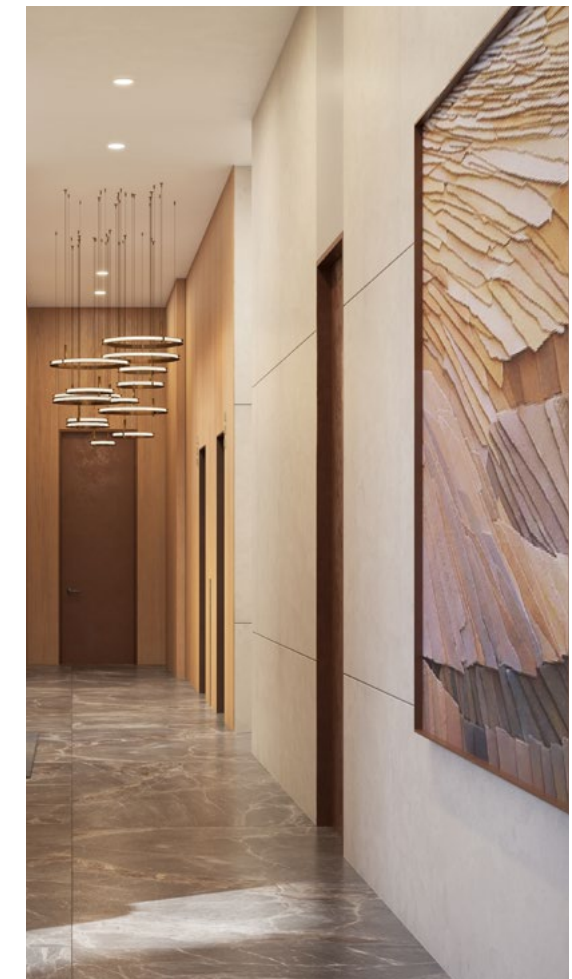
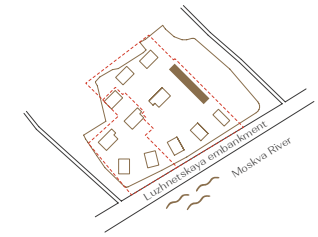

THE CLEAN, POWERFUL LINES  
OF THE BUILDING ARE COMPLEMENTED  
BY INTERIOR DECOR BASED ON LIGHT  
COLORS AND THE UNIQUE TEXTURE  
OF NATURAL STONE TO CREATE A FEELING OF  
INFINITE SPACE AND LIFE IN THE MOUNTAINS.



# MOUNTAIN LINE: DESIGN CONCEPT

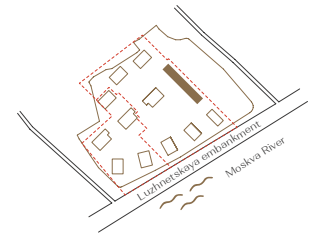
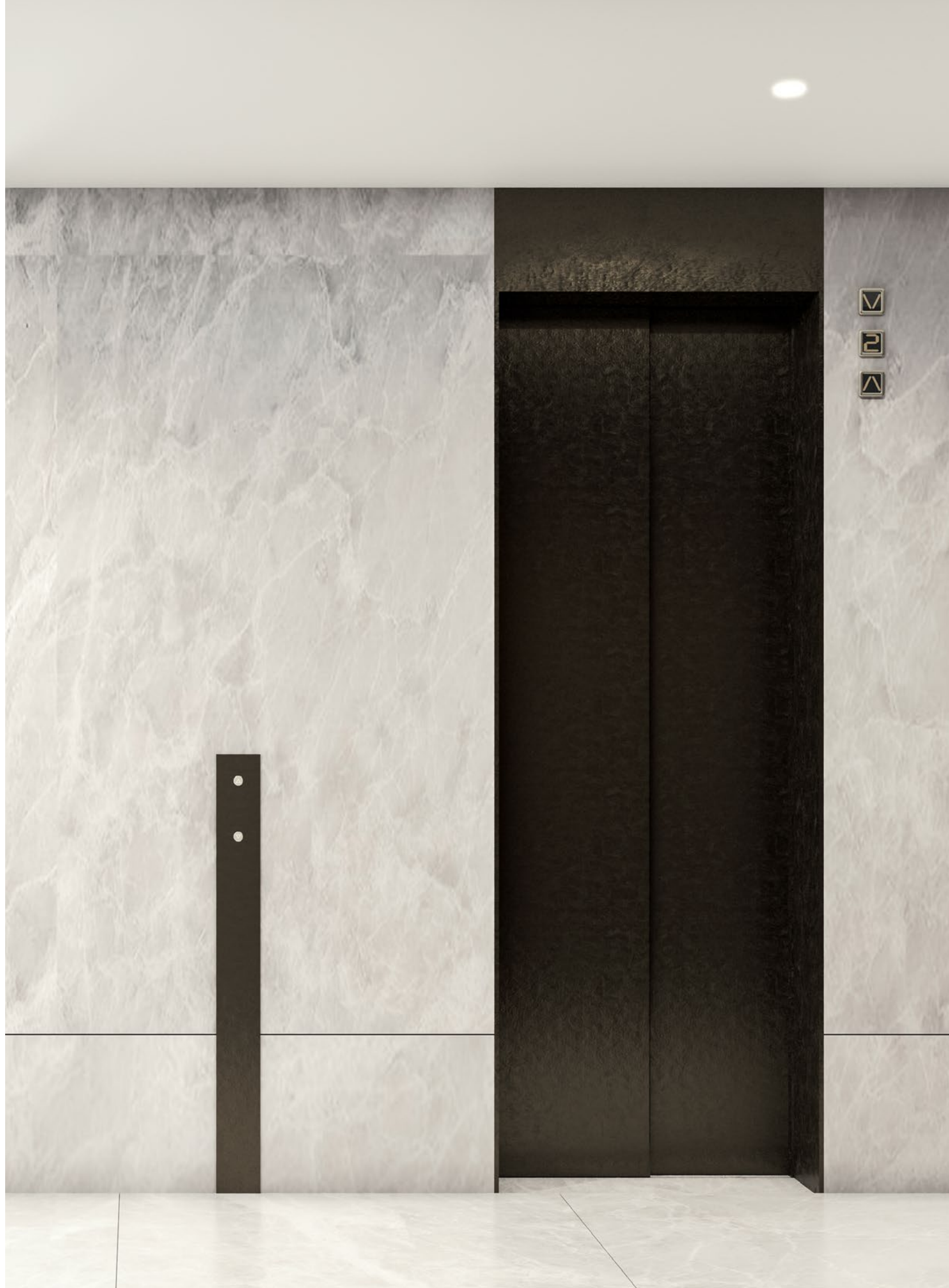



# TECHNICAL SPECIFICATIONS

## SMART APARTMENT

LIGHT CONTROL\*

CLIMATE CONTROL\*

CURTAIN CONTROL\*

WET AREA  
LEAKAGE  
SENSORS\*

## SMART HOME

CONTACTLESS  
ACCESS TO THE SITE  
AND CAR PARKING  
AREAS

APPLICATION  
FOR RESIDENTS

ON-SITE WI-FI

AMENITIES  
BOOKING FACILITY

DOMESTIC  
SERVICES ORDER  
AND PAYMENT

## ENGINEERING

AIR CONDITIONING  
AND VENTILATION  
SYSTEMS

AIR PURIFICATION  
AND HUMIDIFICATION  
SYSTEM

WINDOW  
SOUNDPROOFING  
SYSTEM

UNDERFLOOR  
CONVECTOR  
HEATING SYSTEM

ALL-YEAR-ROUND  
HOT WATER SUPPLY

DRINKING WATER  
STRAIGHT FROM  
THE TAP

WOOD-BURNING  
STOVE INSTALLATION  
SYSTEM\*\*

HIGH-SPEED  
INTERNET

CELL PHONE  
SIGNAL BOOSTER

ELECTRIC VEHICLE  
CHARGING STATIONS

## SAFETY

IP VIDEO DOOR  
PHONE

ROUND-THE-CLOCK  
VIDEO SURVEILLANCE

STATE-OF-THE-ART  
FIRE PROTECTION  
SYSTEM

AUTOMATIC  
FIRE-EXTINGUISHING  
SYSTEM

FIRE ALARM  
PANIC BUTTONS

\*for apartments with  
white-box finish

\*\*for penthouses



# AMENITIES





EACH LUZNIKI COLLECTION BUILDING FOLLOWS A PREMIUM CLUB CONCEPT WITH ACCESS TO PREMISES, AMENITIES (PRIVATE INFRASTRUCTURE ON F1 AND B1 FLOORS) AS WELL AS THE PRIVATE PARK ALLOWED TO RESIDENTS ONLY.

PUBLIC SPACES ARE DESIGNED TO ENSURE UNPARALLELED LEVELS OF COMFORT AND INCLUDE A RESIDENTS-ONLY AMENITIES INFRASTRUCTURE WITH AN ECOSYSTEM OF PRIVATE ROOMS IN EACH CLUBHOUSE.





# AMENITIES: FOR REST AND RELAXATION

LOUNGE FOR REST  
AND EVENTS

AN OPEN FULLY  
EQUIPPED CHEF'S  
KITCHEN

MULTIMEDIA ROOM  
FOR PODCAST  
AND INTERVIEW  
RECORDING

PLAY ROOM

HOBBY CLUB

KIDS CLUB  
FOR CHILDREN  
TO GET CREATIVE IN



# AMENITIES: FOR CHILDREN





# AMENITIES: FOR BUSINESS

BUSINESS ROOMS:  
OFFICES AND MEETING  
ROOMS FOR WORK



# AMENITIES: FOR SPORT AND BEAUTY

MODERN GYM

FITNESS ROOM:  
A PERSONAL  
TRAINING STUDIO

BEAUTY ROOM  
TO INVITE YOUR STYLIST  
OR MAKEUP ARTIST TO





# CAR PARKING





# TWO-LEVEL UNDERGROUND CAR PARKING

4 ENTRANCES  
LOCATED ON DIFFERENT  
SIDES OF THE BUILDING

PERMANENT  
TEMPERATURE  
OF +13°C

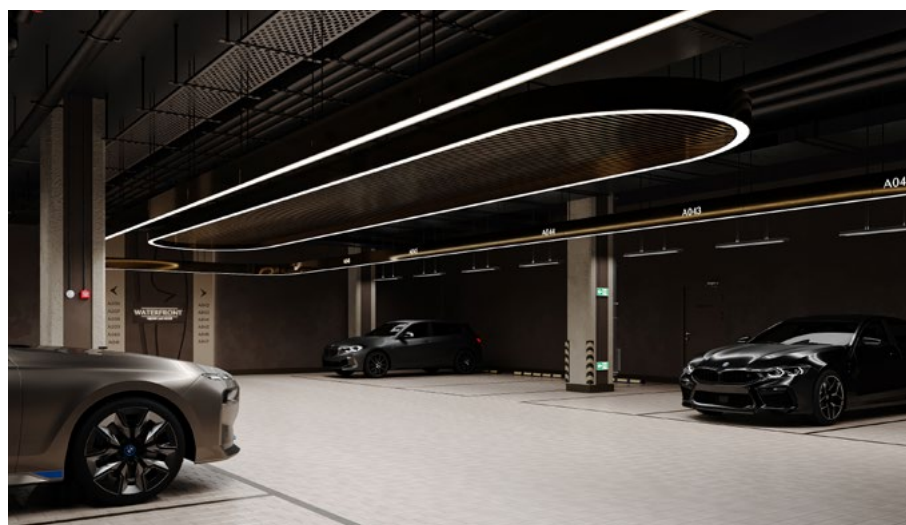

## PRIORITY PARKING

SEPARATE  
ENTRANCE

SECURE  
AREA



DESIGNER  
FINISH

PRIORITY CELLARS



# DROP-OFF

THE DROP-OFF AREA  
AT THE FRONT ENTRANCE  
OF EVERY LUZNIKI COLLECTION  
CLUBHOUSE IS DESIGNED  
WITH THE COMFORT  
AND CONVENIENCE  
OF PASSENGERS IN MIND  
AND FOLLOWS THE PRACTICES  
OF THE WORLD'S BEST HOTELS.

A THOUGHTFUL DETAIL  
FOR RESIDENTS' COMFORT  
WITH A GREEN AREA  
AT THE PARKING LEVEL.





# PRIVATE PARK





# PRIVATE PARK IN DETAIL

LOCATED AT THE VERY CENTER OF THE LUZNIKI COLLECTION PROJECT, THE PRIVATE PARK COVERS AN AREA OF 8 HA. THE PROXIMITY OF THE SURROUNDING HILLS HELPS CREATE A SECLUDED ATMOSPHERE, AND THE PARK OFFERS A NETWORK OF SHADY FOOTPATHS, PROVIDING RESIDENTS WITH A PLEASANT AREA TO REST AND RELAX IN.



THE PARK CONCEPT PROVIDES  
4 SEPARATE LEISURE SPACES:

A SECLUDED  
PRIVATE  
GARDEN

A REVAMPED SECTION  
OF THE LUZHNETSKAYA  
EMBANKMENT

A GORGEOUS  
PIAZZA WITH  
VERANDAS OF  
THE BEST CAFES

THE EXTENSIVELY  
GREENED ROOF  
OF THE RETAIL GALLERY  
ADDS LAYERS TO THE  
PROJECT LANDSCAPING

THE PRIVATE GARDEN IS A SYMBIOSIS OF MODERN  
ENGINEERING AND INNOVATIVE LANDSCAPING.

THE LOWER LEVEL OF THE LUZNIKI COLLECTION  
PROJECT ALLOWS TURNING THE ENTIRE TERRITORY  
INTO A UNIQUE GARDEN WITH A COLLECTION  
OF MATURE TREES OF UP TO 10-12 M HIGH.



# LUZHNIKI OLYMPIC COMPLEX: INFRASTRUCTURE

## ICE PALACE KRISTALL

2 ICE ARENAS  
RESTAURANT  
SPA

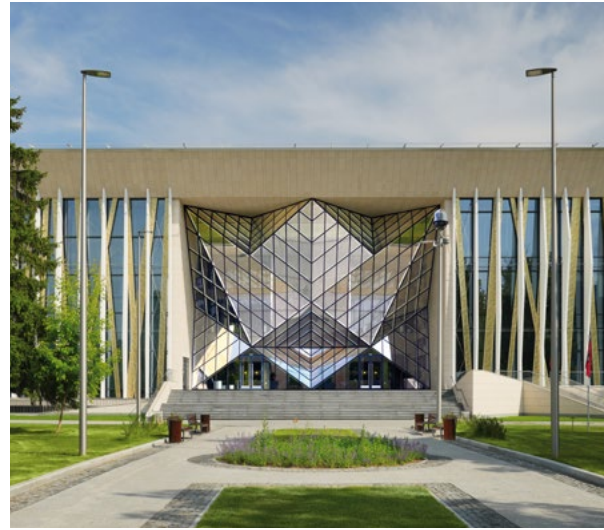

## IRINA VINER-USMANOVA GYMNASTICS PALACE

IRINA VINER-USMANOVA  
GYMNASTICS PALACE  
COMPETITION ARENA  
3 TRAINING HALLS  
CHOREOGRAPHY HALL  
MEDICAL/RECOVERY CENTER



## LUZHNIKI WATER SPORTS PALACE

AQUAPARK  
SWIMMING SCHOOLS  
SWIMMING POOLS  
BOXING ACADEMY  
CROCUS FITNESS CENTER  
EUROPEAN  
GYMNASTICS CENTER  
TRIATHLON CENTER  
NALU BALOO SURFING  
THERMAL  
HEALTH COMPLEX  
V SPA  
VOLANGE BEAUTY STUDIO  
AQUAMARINE RESTAURANT  
AQUA CAFE  
SHOPPING GALLERY



## INTERNATIONAL SAMBO AND BOXING CENTER

SAMBO CENTER  
• EVENT HALL WITH 3 MATS  
AND SEATING FOR 1 600 GUESTS  
• VIP BOX  
• TRAINING HALL WITH 6 MATS  
BOXING CENTER  
• EVENT HALL WITH 2 RINGS  
AND SEATING FOR 2 000 GUESTS  
• VIP BOX  
• TRAINING HALL WITH 3 RINGS  
AND 1 WRESTLING MAT  
SWIMMING POOL  
EXERCISE MACHINES  
SPORTS HALL



## SHOOTING SPORTS CLUB\*

4 SHOOTING  
GALLERIES  
INTERACTIVE  
SHOOTING RANGE  
SHOOTING SPORTS  
ACCESSORIES SHOP



## UNIVERSAL SPORTS HALL DRUZHBA\*

3 MULTI-FUNCTION ROOMS  
FITNESS CENTER  
CONFERENCE HALL  
SPORTING EVENT  
AND CONCERT VENUE  
TENNIS  
TABLE TENNIS



## BIG SPORTS ARENA

NATIONAL STADIUM  
OF THE RUSSIAN  
FEDERATION  
FORT LUZHNIKI  
CHILDREN'S QUEST AREA  
STADIUM ROOF TOUR  
PANDAPARK ZIPLINE  
CROSSFIT 19.05 GYM  
PADEL FRIENDS SCHOOL  
LUZHNIKI SPORTS  
MEDICINE CLINIC

## MULTISPORT SPORTS CLUB

6 TENNIS COURTS  
POOL  
RACKETLON: SQUASH,  
BADMINTON, PADEL  
AND TABLE TENNIS  
UNIVERSAL GYM  
3 TRUGOLF SIMULATORS





# LUZHNIKI OLYMPIC COMPLEX: SPORT

- |    |  |
|----|--|
| 1  | BIG SPORTS ARENA                               |
| 2  | WORKOUT AREAS                                  |
| 3  | YASPORT CLUB                                   |
| 4  | BOSCO TENNIS CLUB                              |
| 5  | FOOTBALL FIELDS WITH NATURAL GRASS             |
| 6  | FOOTBALL FIELDS WITH ARTIFICIAL GRASS (HEATED) |
| 7  | LUZHNIKI WATER SPORTS PALACE                   |
| 8  | IRINA VINER-USMANOVA GYMNASTICS PALACE         |
| 9  | OUTDOOR WATER COMPLEX                          |
| 10 | NORTH SPORTS CENTER                            |
| 11 | FOOTBALL FIELDS                                |
| 12 | SOUTH SPORTS CENTER                            |
| 13 | SPORTS CITY                                    |
| 14 | LUZHNIKI TENNIS PALACE                         |
| 15 | ICE PALACE KRISTALL                            |
| 16 | SHOOTING SPORTS CLUB*                          |
| 17 | PARIS SAINT-GERMAIN FOOTBALL ACADEMY           |
| 18 | DRUZHBA MULTI-PURPOSE SPORTS HALL*             |
| 19 | INTERNATIONAL SAMBO AND BOXING CENTER          |
| 20 | MULTISPORT SPORTS CLUB                         |

\*UNDER CONSTRUCTION





# LUZHNIKI OLYMPIC COMPLEX: LEISURE

- 1 BIG SPORTS ARENA  
FORT LUZHNIKI CHILDREN'S  
QUEST AREA  
STADIUM ROOF TOUR
- 2 LUZHNIKI  
WATER SPORTS PALACE  
AQUAPARK  
THERMAL HEALTH COMPLEX  
V SPA BEAUTY SALON  
VOLANGE BEAUTY STUDIO  
AQUAMARINE RESTAURANT  
(NOVIKOV GROUP)  
AQUA CAFE (NOVIKOV GROUP)
- 3 OUTDOOR SWIMMING POOL
- 4 IRINA VINER-USMANOVA  
GYMNASTICS PALACE  
MEDICAL/RECOVERY CENTER  
CHOREOGRAPHY HALL
- 5 SOUTH SPORTS CENTER  
ICE RINK
- 6 ZIPLINE IN THE PANDAPARK
- 7 PANDAPARK
- 8 CLIMBING WALLS
- 9 INTERNATIONAL SAMBO  
AND BOXING CENTER
- 10 OLYMP JUNIOR RESTAURANT
- 11 VERANDA RIVERSIDE  
RESTAURANT  
(ARS ROYAL GROUP)
- 12 VERANDA LOUNGE CAFE
- 13 MOSCOW CABLE CAR
- 14 LUZHNIKI-TSENTRALNY PIER
- 15 SKYPARK MOSCOW ZIPLINE



# URBAN INFRASTRUCTURE





# RETAIL GALLERY

THE RETAIL GALLERY  
INTEGRATED INTO  
THE PODIUM OF THE  
LUZHNIKI COLLECTION  
CONTINUES  
THE ARCHITECTURAL  
THREAD OF THE PROJECT.

CREATED BY A GROUP  
OF LEADING URBAN  
DESIGNERS, THE GALLERY  
PROVIDES A SHOPPING  
INFRASTRUCTURE TO MEET  
THE HIGH EXPECTATIONS  
OF THE LUZHNIKI  
COLLECTION'S TARGET  
AUDIENCE.





# CULTURE & LEISURE CENTER

THE CULTURE & LEISURE CENTER WILL HOUSE A COMPREHENSIVE RANGE OF RECREATIONAL AND ENTERTAINMENT OPTIONS, OFFERING EVERYTHING FROM SOUND-PROOFED CINEMA ROOMS FOR PRIVATE SCREENING TO DISPLAY AREAS FOR THE MODERN ART EXHIBITIONS OF LEADING GALLERIES.

A CHILDREN'S ENTERTAINMENT CENTER AND AN OUTDOOR ROOF SUMMER CINEMA ARE CURRENTLY UNDER DEVELOPMENT.





# BUSINESS CLUSTER

2 MODERN CLASS A+  
BUSINESS CENTERS  
DESIGNED USING  
INNOVATIVE GREEN  
TECHNOLOGY  
IN A BUSINESS PARK  
FORMAT WILL INCLUDE  
STATE-OF-THE-ART  
WORKPLACES  
AND RECREATION AREAS  
FOR THE CLUSTER'S  
EMPLOYEES.





# PIAZZA

A SPACIOUS URBAN AREA  
INTENDED FOR USE  
AS AN EXHIBITION SPACE  
FOR PUBLIC ART, THE PIAZZA  
WILL BECOME A CALLING CARD  
OF THE LUZHNIKI COLLECTION.

IN ADDITION TO A PLEASANT  
PLACE TO STROLL AROUND,  
INNOVATIVE FUNCTIONAL  
ZONING HAS BEEN USED  
TO CREATE AREAS TO WORK  
OR HOLD BUSINESS MEETINGS IN.





# PROJECT PARTICIPANTS

## MASTER PLAN

**SIMPSON HAUGH** IS A TEAM OF BRITISH ARCHITECTS ACTIVE SINCE 1987 IN ALL AREAS OF ARCHITECTURE. THE TEAM'S PORTFOLIO INCLUDES A WIDE VARIETY OF PROJECTS FROM GENERAL PLANNING TO INTERIORS.

SIMPSON HAUGH PROPOSED AND DEVELOPED THE POSITIONING OF THE PROJECT BUILDINGS THAT WOULD ALLOW THE SITE'S INTERNAL AREAS AND PUBLIC SPACES TO BE PRESERVED.

## ARCHITECTURE

**DYER** IS A BRITISH MULTIPLE AWARD-WINNING ARCHITECTURE AND DESIGN COMPANY WITH OVER 50 YEARS OF EXPERIENCE, OPERATING IN THE UK AND INTERNATIONALLY.

DYER'S ARCHITECTS HELPED DEVELOP THE SITING AND ARCHITECTURE OF THE BUILDINGS. THE UNIQUE IDEA OF A PODIUM ALLOWED PROVIDING ALL BUILDINGS WITH DIRECT VEHICLE ACCESS TO THE LOBBY WHILE KEEPING THE PREMISES FREE OF CARS AND ENSURING AN UNRESTRICTED VIEW OF THE AREA FROM THE EMBANKMENT SIDE.

## OFFICE

**ABD ARCHITECTS** HAS BEEN SUCCESSFULLY IMPLEMENTING ARCHITECTURAL AND INTERIOR PROJECTS FOR 29 YEARS. THE COMPANY IS A MEMBER OF THE RUGBC, AMCHAM AND MCFO ASSOCIATIONS, AND WAS ONE OF THE FIRST TO DEVELOP THE CONCEPT OF SUSTAINABLE DESIGN IN THE RUSSIAN OFFICE SECTOR.

THANKS TO THEIR EXPERIENCE, ABD'S EXPERTS HELPED SOLVE THE CHALLENGING PROBLEM OF BUILDING A MULTIFUNCTIONAL COMPLEX NEXT TO THE THIRD RING ROAD AND CREATING AN ORGANIC LINK WITH THE ARCHITECTURE AND HISTORY OF THE DISTRICT.

## GENERAL DESIGN

**APEX PROJECT BUREAU** IS A MOSCOW COMPANY CREATED IN 2014 TO PROVIDE A FULL RANGE OF SERVICES IN A UNIFIED BIM ENVIRONMENT. THE APEX TEAM BRINGS TOGETHER MORE THAN 900 SPECIALISTS INCLUDING ARCHITECTS, DESIGNERS, ENGINEERS, AND PROJECT MANAGERS WHOSE COMPETENCIES AND EXPERIENCE HAVE ALLOWED IT TO BECOME AN ACKNOWLEDGED MARKET LEADER IN THE FIELD OF GENERAL DESIGN IN RUSSIA. WITH APEX, WE CAN SAVE OUR CLIENTS TIME AND MONEY BY ENSURING EFFECTIVE RESULTS AT ALL STAGES OF PROJECT IMPLEMENTATION.

APEX HELPED HARMONIZE THE MANY VARIED IDEAS OF THE PROJECT'S INTERNATIONAL TEAM OF ARCHITECTS AND ENSURED THE DEVELOPMENT OF ENGINEERING SOLUTIONS THAT MEET THE HIGHEST STANDARDS OF THE CONSTRUCTION INDUSTRY.

## MASTER PLAN

**AUKETT SWANKE** (UNITED KINGDOM) IS AN AWARD-WINNING TEAM OF ARCHITECTS AND DESIGNERS WITH OVER 60 YEARS OF PROFESSIONAL EXPERIENCE. THE COMPANY IMPLEMENTS A WIDE RANGE OF ARCHITECTURAL PROJECTS, INCLUDING GENERAL PLANNING AND INTERIOR DESIGN.

THE BUREAU HELPED FINISH A CONSTRUCTION CONCEPT THAT WOULD DELIVER AS MUCH OPEN SPACE AS POSSIBLE.

## SUPERVISION & CINEMA

**MVRDV** IS A WORLD-FAMOUS NETHERLANDS-BASED DESIGN PRACTICE. FOUNDED IN 1991, IT HAS CREATED MANY OUTSTANDING EXAMPLES OF PROGRESSIVE ARCHITECTURE IN THE NETHERLANDS, FRANCE, DENMARK, SPAIN, CHINA, JAPAN, AND THE USA. RECEIVING MANY INTERNATIONAL AWARDS, MVRDV'S ACHIEVEMENTS ARE EXHIBITED AND PUBLISHED AROUND THE WORLD.

THE UNIQUE AND EASILY IDENTIFIABLE SHAPE OF THE LEISURE CENTER DESIGNED BY MVRDV WILL BECOME ONE OF THE DISTRICT'S MOST NOTABLE ARCHITECTURAL FEATURES AS WELL AS OBJETS D'ART OF THE LUZHNetskAYA EMBANKMENT. MVRDV ALSO TOOK ON THE TASK OF CONSOLIDATING THE IDEAS OF THE VARIOUS PROJECT ARCHITECTS AND CREATING A COMPREHENSIVE IMAGE OF THE SITE.

## INTERIOR

**ODA** IS AN OFFICE OF ARCHITECTURE FOUNDED IN NEW YORK IN 2007. ITS AWARD-WINNING TEAM OF DESIGNERS AND ARCHITECTS HAVE EXPERIENCE IN A WIDE RANGE OF FIELDS, FROM ARCHITECTURE AND MASTER PLANNING TO LANDSCAPING AND INTERIOR DESIGN. BY 2021, ODA HAD ALREADY COMPLETED SOME 40 CONSTRUCTION PROJECTS. THE COMPANY HAS HAD A MAJOR INFLUENCE ON URBAN AND INTERIOR DESIGN IN VARIOUS COUNTRIES WORLDWIDE.

ODA'S UNMATCHED SENSE OF SPACE AND STYLE LARGELY DEFINED THE UNIQUENESS OF THE 12 CLUBHOUSE INTERIORS, THE ENTRANCE LOBBIES, AND NUMEROUS ITEMS OF INFRASTRUCTURE.

## GENERAL CONTRACTOR

**ENKA** THE GENERAL CONTRACTOR ENSURES THE HIGHEST QUALITY OF PROJECT REALIZATION. THE FULL CONSTRUCTION CYCLE FROM DESIGN DOCUMENTATION TO FINAL FINISHING WORKS IN CLUBHOUSES IS HANDLED BY THE SPECIALISTS OF A MAJOR INTERNATIONAL CONSTRUCTION COMPANY. THE GENERAL CONTRACTOR'S EXPERIENCE IN THE CONSTRUCTION OF INNOVATIVE AND PREMIUM PROPERTIES ON AN INTERNATIONAL SCALE IS A GUARANTEE OF AN UNRIVALLED LEVEL OF WORKMANSHIP AND QUICK CONSTRUCTION RATES FOR LUZHNIKI COLLECTION RESIDENTS.

ENKA İNŞAAT VE SANAYİ A.Ş. (ENKA) IS AN INTERNATIONAL COMPANY THAT PROVIDES ENGINEERING DESIGN AND CONSTRUCTION SERVICES. ITS PORTFOLIO INCLUDES SUCH INNOVATIVE AND HIGH-PROFILE PROJECTS IN MOSCOW AS THE YANDEX HEADQUARTERS, EMPIRE AND EURASIA TOWERS IN THE MOSCOW INTERNATIONAL BUSINESS CENTE, THE WHITE SQUARE BUSINESS CENTER, THE TSVETNOY MULTIFUNCTIONAL COMPLEX, AND THE SADOVAYA PLAZA CLASS-A BUSINESS CENTER.



# CONTACTS



🌐 ABS-PREMIUM.RU  
LUZHNIKI-COLLECTION.RU

☎ +7 495 795 07 07  
ABSOLUT PREMIUM OFFICE SALES,  
54 FRUNZENSKAYA EMBANKMENT, MOSCOW



SEE MAP

